

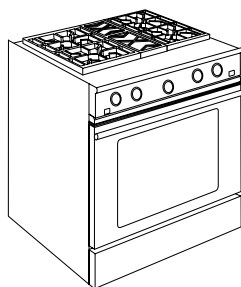

*GE Consumer & Industrial*

# TECHNICAL SERVICE GUIDE

## Monogram Dual Fuel Pro Ranges And Monogram Gas Cooktops

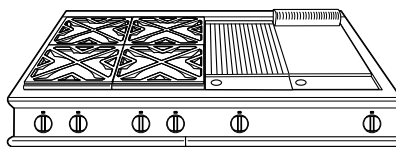
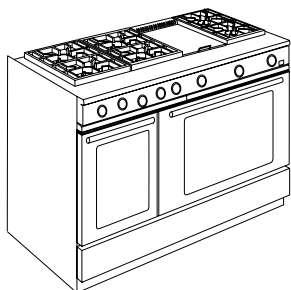

### MODEL SERIES:

ZDP30\_\_H

ZDP36\_\_\_H

ZDP48\_\_\_H

ZGU36\_\_\_H

ZGU48\_\_\_H





### **IMPORTANT SAFETY NOTICE**

The information in this service guide is intended for use by individuals possessing adequate backgrounds of electrical, electronic, and mechanical experience. Any attempt to repair a major appliance may result in personal injury and property damage. The manufacturer or seller cannot be responsible for the interpretation of this information, nor can it assume any liability in connection with its use.

### **WARNING**

If the information in this manual is not followed exactly, a fire or explosion may result causing property damage, personal injury or death. If you smell gas:

- Do not try to light any appliance.
- Do not touch any electrical switch; do not use any phone in the building.
- Immediately call the gas supplier from a neighbor's phone. Follow the gas supplier's instructions.
- If you cannot reach the gas supplier, call the fire department.

### **WARNING**

To avoid personal injury, disconnect power before servicing this product. If electrical power is required for diagnosis or test purposes, disconnect the power immediately after performing the necessary checks.

### **RECONNECT ALL GROUNDING DEVICES**

If grounding wires, screws, straps, clips, nuts, or washers used to complete a path to ground are removed for service, they must be returned to their original position and properly fastened.

***GE Consumer & Industrial***

*Technical Service Guide*

*Copyright © 2004*

All rights reserved. This service guide may not be reproduced in whole or in part in any form without written permission from the General Electric Company.

## TABLE OF CONTENTS

Blower Thermal Cutout .....	16
Burner Alignment .....	12
Burner Valve .....	11
Check for Proper Ignition .....	12
Component Access .....	8
Component Locator Views .....	6
Components .....	8
Convection Fan Assembly .....	18
Door Assemblies .....	9
Flame Characteristics .....	11
Grates .....	12
Griddle Leveling .....	15
Griddle Removal .....	14
Griddle Thermostat Adjustment .....	15
Grill Burner/Griddle Burner Ignition Systems (On Some Models) .....	13
Grill or Griddle Air Adjustment .....	15
Grill or Griddle Igniter Removal .....	16
Grill Removal .....	14
Ignition and Re-ignition .....	12
Introduction .....	4
Lock Motor Assembly .....	19
Nomenclature .....	5
Orifice Conversion Kits .....	11
Oven Blower Motor (30-in. Range Models) .....	20
Oven Blower Motor (36-in. and 48-in. Range Models) .....	19
Oven Door .....	8
Oven Light Bulbs .....	10
Oven Select Switches .....	17
Oven Thermostat .....	17
Oven Thermostat Calibration .....	16
Relays, Convection Pulsar Timers and Main Power Connection .....	17
Schematics and Wiring Diagrams .....	21
Simmer Orifice Burner Replacement .....	11
Sparking .....	12
Spark Module .....	13
Surface Burner .....	10
Surface Burner Adjustments .....	11
Warranty .....	30

# Introduction



**36-in. Range Shown with Center Grill**

The Monogram Ranges are available in 30-in., 36-in. and 48-in. configurations. The 36-in. can have 6 burners, no grill or griddle or 4 burners with grill or griddle. The 30-in. and 36-in. models have a 27-in. self-cleaning oven and the 48-in. model has an additional 12-in. standard clean oven.

The gas cooktop-only models are available in 36-in. and 48-in. configurations with the same grill and griddle combinations as the cooktop on the 36-in. and 48-in. range models.

All models are available in either natural gas or LP gas and must be ordered appropriately from the dealer at the time of purchase.



**48-in. Range Shown with Grill, Griddle, and 12-in. Oven**

# Nomenclature

## Model Number

**Z D P 4 8 N 4 G H 1 S S**

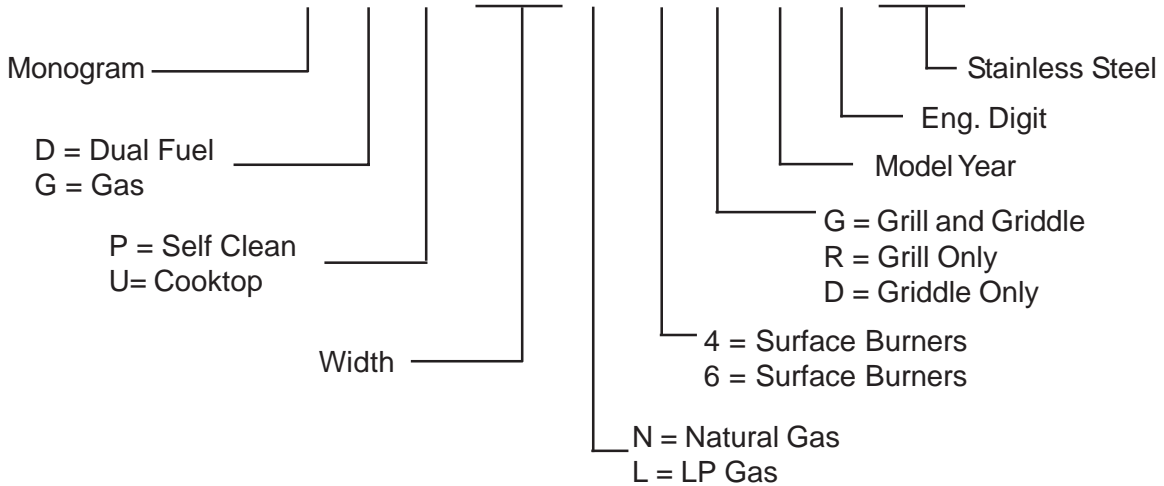

## Serial Number

The first two numbers of the serial number identify the month and year of manufacture.

*Example:* **AG123456S** = January, 2004

<b>A</b> - JAN	2005 - <b>H</b>
<b>D</b> - FEB	2004 - <b>G</b>
<b>F</b> - MAR	2003 - <b>F</b>
<b>G</b> - APR	2002 - <b>D</b>
<b>H</b> - MAY	2001 - <b>A</b>
<b>L</b> - JUN	2000 - <b>Z</b>
<b>M</b> - JUL	1999 - <b>V</b>
<b>R</b> - AUG	1998 - <b>T</b>
<b>S</b> - SEP	1997 - <b>S</b>
<b>T</b> - OCT	1996 - <b>R</b>
<b>V</b> - NOV	1995 - <b>M</b>
<b>Z</b> - DEC	1994 - <b>L</b>

The letter designating the year repeats every 12 years.

*Example:*

*T* - 1974

*T* - 1986

*T* - 1998



The mini-manual is located behind the bottom cover.

Nomenclature information is located on the back of the range.

# Component Locator Views

## 36-in. Range Models

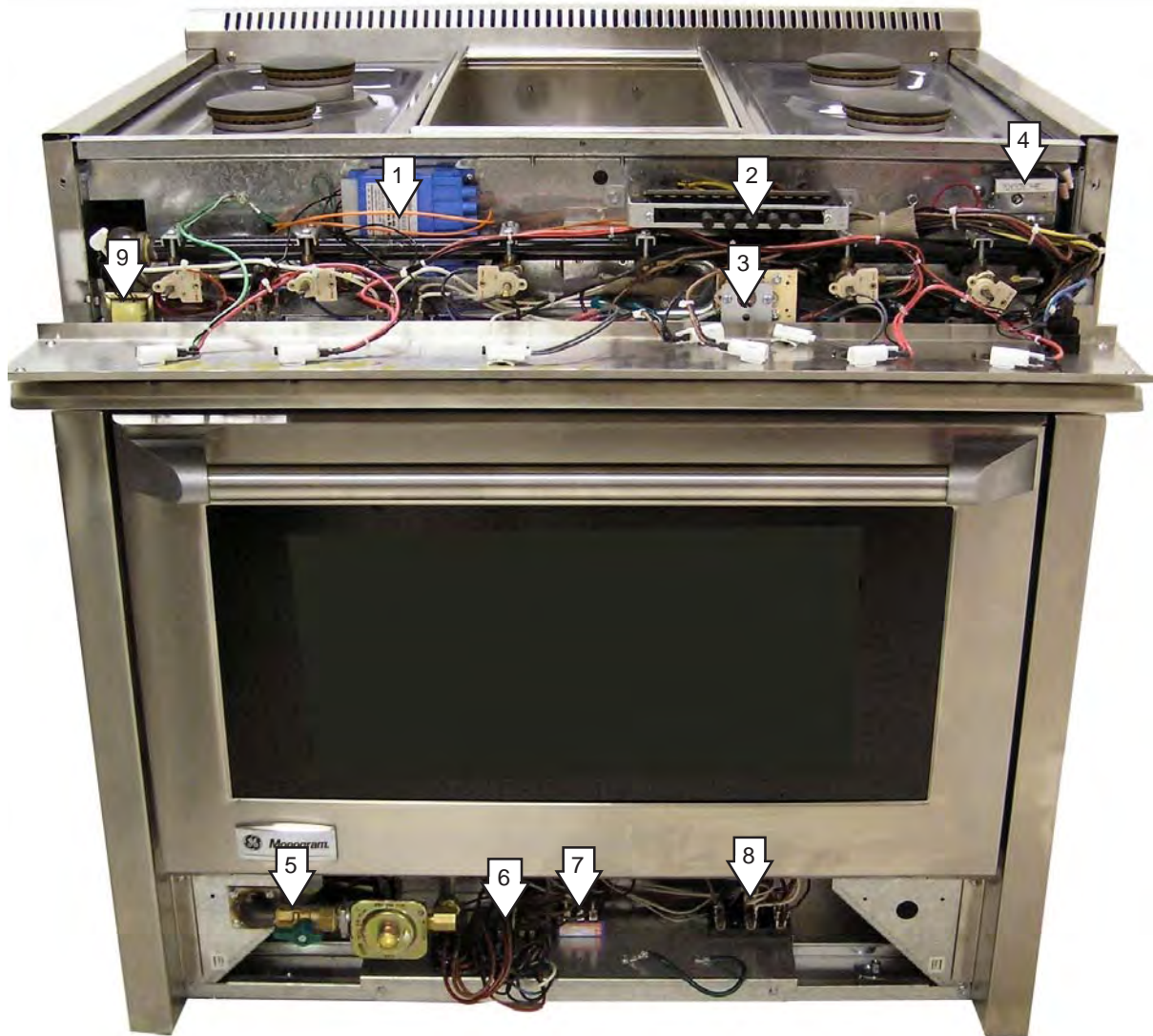

1 - Spark Module

2 - Oven Select Switches

3 - Oven Control

4 - Door Lock High Limit

5 - Gas Shut-Off Valve

6 - Relays

7 - Clean Timer

8 - Terminal Block

9 - Transformer



## 48-in. Range Models

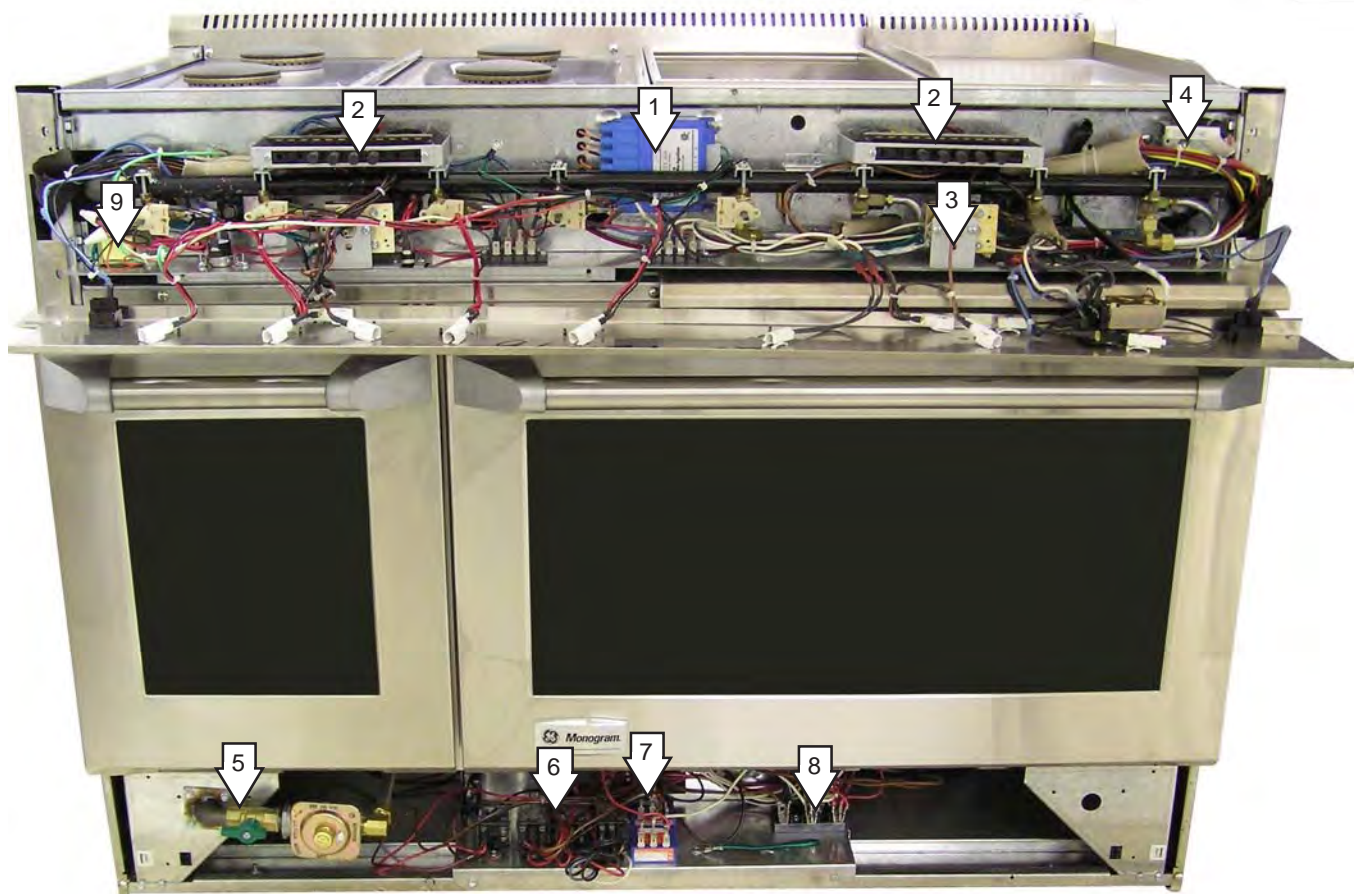

1 - Spark Module

2 - Oven Select Switches

3 - Oven Control

4 - Door Lock High Limit

5 - Gas Shut-Off Valve

6 - Relays

7 - Clean Timer and Proof Timer

8 - Terminal Block

9 - Transformer

# Components

## Component Access

### All 36-in. and 48-in. Models

1. Remove the manifold/valve panel:
  - a. Remove the knobs from the control valves.
  - b. Remove the 4 Torx screws located at each corner of the manifold/valve panel.
  - c. Carefully pull off the panel. **(Do not scratch the panel.)**
2. Remove the landing ledge:
  - a. Slide the right-side drip tray out (models with a grill or griddle).
  - b. Remove the 4 Phillips head screws holding the landing ledge in place, and lift the ledge off.

### 48-in. Range Model Shown

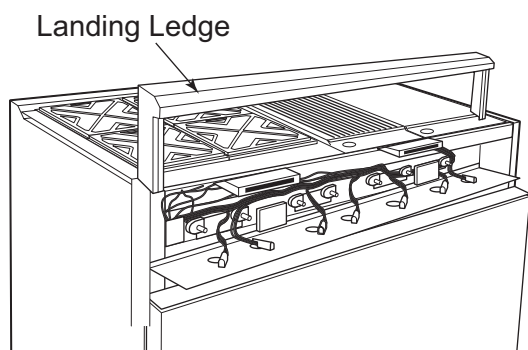

### 30-in. Range Models

1. Remove the manifold/valve panel. (See 36-in. and 48-in. Models.)
2. Remove the landing ledge:
  - a. Remove the 4 Phillips head screws holding the landing ledge in place, and lift the ledge off.

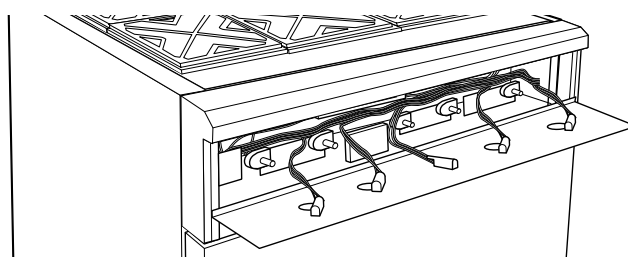

## Oven Door

### To remove the door:

1. Fully open the door.
2. Each hinge has a hinge lock. Close the hinge latches down against the door frame.
3. Firmly grasp the door at the top sides.
4. Close the door to the near-vertical position.
5. Lift the door up and pull straight out.

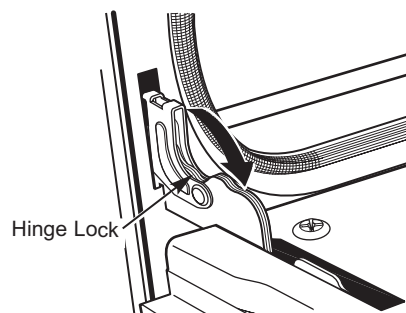

Pull the hinge locks down to unlock.



## To install the door:

1. Firmly grasp the door at the top sides. **This is critical.**
2. Approach the range with the door angled in a vertical position.
3. Guide the hinges into the slots.
4. Push the door in firmly while opening.
5. Once in position, open the door completely. Push the hinge locks back in and toward the front frame.

**Note:** If the door cannot be fully opened, the hinge is not properly seated.

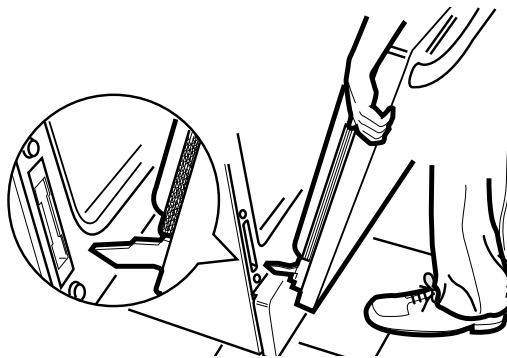

## Door Gasket

The gasket is attached to the front frame around the outer edge of the oven liner. A series of spring clips mounts the gasket to the front frame. The ends are tucked into the front frame at the bottom of the oven liner, leaving approximately 15 inches of opening across the bottom for air intake on self-clean models. The gasket stops just above the hinges on the standard oven.

### 27-in. Oven

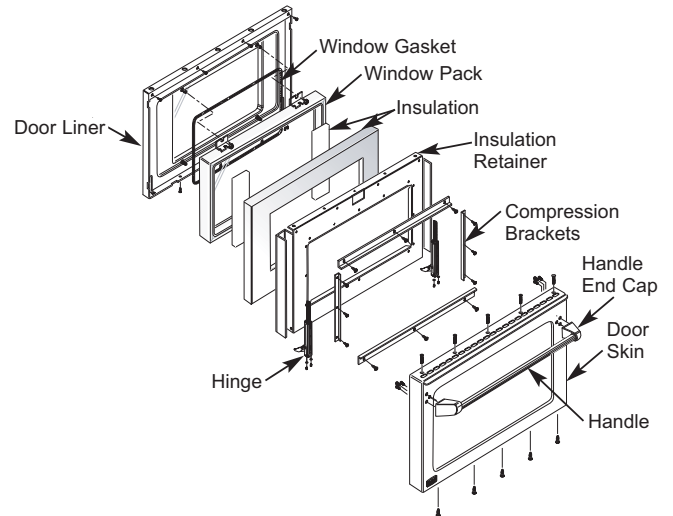

## Door Assemblies

### 12-in. Oven Door (48-in. Range Model Only)

The oven door consists of outer and inner assemblies. The outer assembly consists of the outer panel and glass along with the handle and spacers. The inner assembly consists of the window pack, insulation guard, inner door panel and hinges.

### 27-in. Oven Door (30-in., 36-in. and 48-in. Range Models)

The oven door consists of an outer and inner assembly. The outer assembly consists of an outer panel and glass along with the handle and spacers. The inner assembly is made up of the window pack, insulation guard, inner door panel, hinges and window pack gasket.

### 12-in. Oven (48-in. Range Models Only)

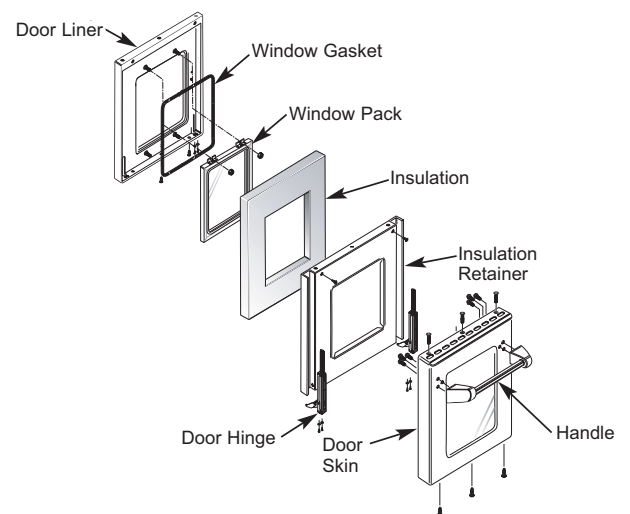

## Oven Light Bulbs

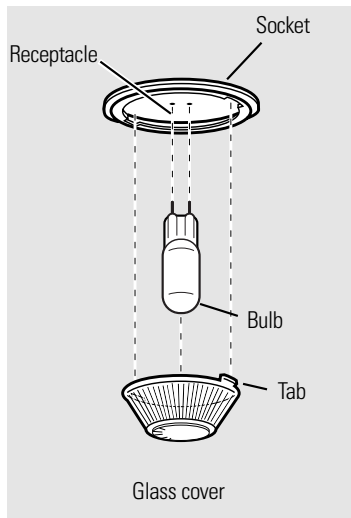

**Caution:** Before replacing the oven light bulb, disconnect the electrical power to the range at the main fuse or circuit breaker panel.

**Note:** Allow light cover and bulb to cool completely.

Replace with a new 130V halogen bulb, not to exceed 35 watts.

### To remove and replace the oven light bulb:

1. Turn the glass cover counterclockwise  $\frac{1}{4}$  turn until the tabs of the glass cover clear the grooves of the socket.
2. Using gloves or a dry cloth, remove the bulb by pulling it straight out.
3. Using gloves or a dry cloth, remove the new bulb from its packaging. **Do not touch the bulb with bare fingers.**
4. Push the bulb straight into the receptacle all the way. Place the tabs of the glass cover into the grooves of the socket. Turn the glass cover clockwise  $\frac{1}{4}$  turn to engage.
5. For improved lighting inside the oven, clean the glass cover frequently using a wet cloth. This should be done when the oven is completely cool.
6. Reconnect electrical power to the oven.

## Surface Burner

### To remove the surface burner:

1. Lift off the burner cap and burner head.
2. Remove the burner ring locking nut using a  $\frac{1}{16}$ -in. socket wrench, crescent wrench or channel-lock pliers.
3. Lift off the burner ring. **Do not remove the burner base.**

### To replace the surface burner:

1. Align the locator pins on the burner ring into the labeled hole in the burnerbase. Seat in place and push toward the electrode to set gap properly.
2. Replace the burner ring locking nut. Tighten the nut three times to remove small imperfections in the parts. This will ensure the nut remains tight over life:
  - Hand tighten nut, tighten  $\frac{1}{4}$  turn with wrench or pliers, then loosen.
  - Hand tighten nut a second time, tighten  $\frac{1}{4}$  turn with wrench or pliers, then loosen.
  - Hand tighten nut and final tighten  $\frac{1}{4}$  turn with wrench or pliers.
3. Align the locator pin in the burner head into the hole in the burner ring. Seat in place.
4. Replace the burner caps.

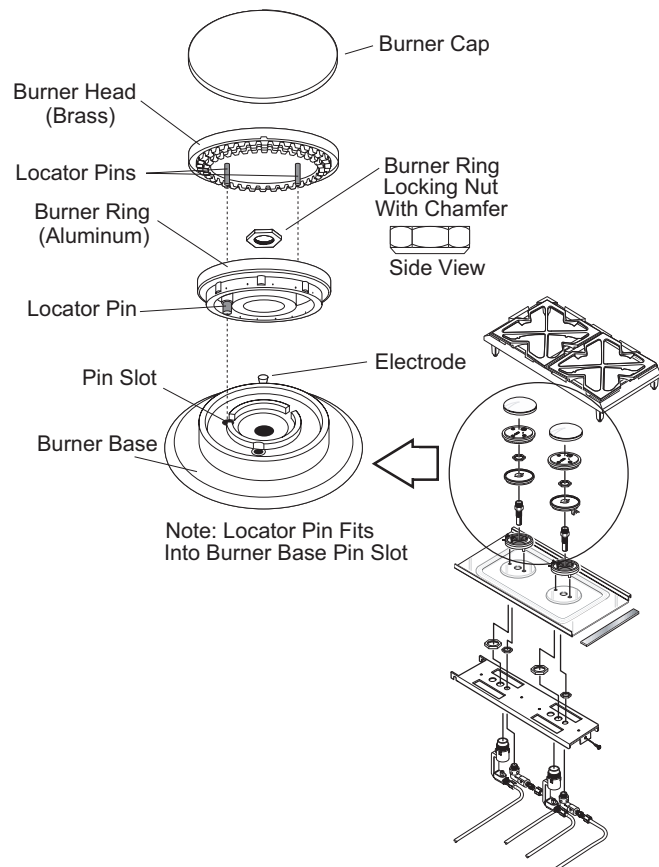

## Burner Valve

The burner valves are attached to the manifold by two screws and contains an orifice which sets the flow rate for the simmer flame. This valve does not have a low flame adjustment, it is controlled by the orifice size.

## Simmer Orifice Burner Replacement

The simmer burner orifice requires a 4mm socket to remove it. If necessary a 4mm socket is available under part # WX05x10006.

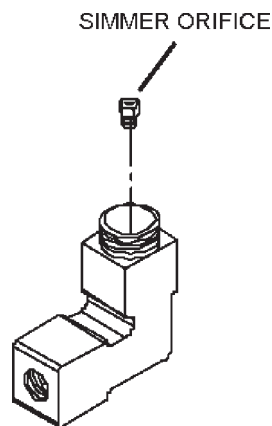

## Surface Burner Adjustments

Standard adjustments to the air shutter and gas metering orifices are not possible on sealed burners.

If burner flames appear to be abnormal, check the following:

- Check gas pressure available to the burners. The required operating pressure is 5" W.C.P. Natural Gas or 10" W.C.P. L.P. (Propane) Gas.
- Check for drafts entering the burner box from behind the cooktop.
- Check for blockage or partial blockage of the orifice. Inspect the orifice to be sure it has been drilled on center and is free of debris or burrs.
- Check the burner alignment per **Burner Alignment**.
- If the cause of the problem cannot be found, installing an orifice with smaller diameter openings may solve the problem. In high altitude (above 6000 ft.) installation, the orifices will usually have to be downsized.

## Flame Characteristics

Burner flames should be blue and stable with no yellow tips. (Yellow tipping may be normal for LP gas.) The flame should not have excessive noise or lifting of the flame from the burner. If any of these conditions exist, check the burner ports for blockage.

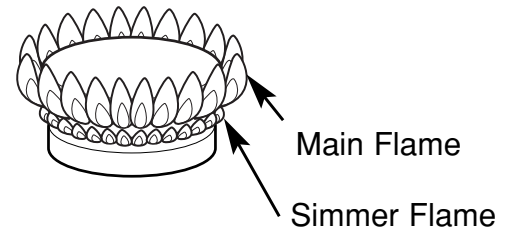

## Orifice Conversion Kits

Burner orifice conversion kits are available for:

- Converting burner orifices from LP to Natural Gas and from Natural Gas to LP
- Installation at high altitudes

Natural/LP Conversion Kit - Order part number WB49X10132

LP/Natural Conversion Kit - Order part number WB49X10133

High Altitude Conversion Kit – Order part number WB49X10130

### ORIFICE/JET SIZES

#### ORIFICE/JET SIZES

BURNER	GAS	ORIFICE (mm)			RATE (BTU/HR)			MAIN ORIFICE CODE	SIMMER ORIFICE CODE
		MAIN	SIMMER	Valve	HI	LO	SIM		
D BURNER	NG	1.85	0.57 mm	0.57	17k	2700	1300	185	P
D BURNER	LP	1.18	0.34 mm	0.34	15k	2500	1200	118	E
GRILL/GRIDDLE	NG	1.93	—	0.94	18k	6000	—	48	—
GRILL/GRIDDLE	LP	1.32	—	0.47	18k	6000	—	55	—

#### HIGH ALTITUDE CONVERSION

Recommended Orifice Size for High Altitude Installation

BURNER	GAS	Sea Level	3000 ft.	6000 ft.
		MAIN Orifice (mm)		
D BURNER	NG	1.85	1.78	1.61
D BURNER	LP	1.18	1.09	1.07
GRILL/GRIDDLE	NG	1.93	1.85	1.70
GRILL/GRIDDLE	LP	1.32	1.32	1.18

## Grates

To repair damaged feet on range cooktop grates, order the repair kit, part # WB2X11095.

## Burner Alignment

Burner alignment is very important for proper operation. Make sure the locator pin on the burner ring is properly aligned with the hole on the burner base. Each brass burner head is marked with a clock face. Replace the burner head with the arrow pointing to the rear of the cooktop (12 o'clock position).

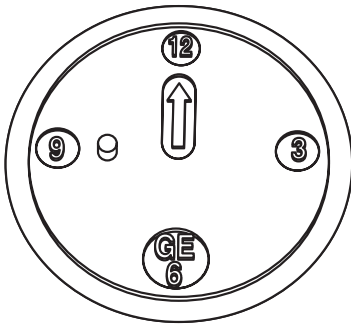

## Check For Proper Ignition

All the igniters make clicking sounds and spark even when only a single burner is being turned on. Do not touch any of the burners when the igniters are clicking.

1. Push in one control knob and turn 90° to LITE position.
2. The igniter will spark and the burner will light; the igniter will cease sparking when the burner is lit.
3. The first test may require some time while air is flushed out of the gas line.
4. Turn knob to OFF.
5. Repeat the procedure for each burner.

## Ignition and Re-ignition

The ignition systems consists of 3 major components.

- Transformer
- Spark Module
- Electrodes and Associated Wiring

Features of the cooktop determine whether the ignition system uses a 4 or 5 wire spark module. The spark modules are rated at 240v and have an internal transformer. The internal transformer serves two functions.

- An isolation device to prevent random sparking in reverse polarity situations.
- To increase the input voltage from 120v to 240v.

During the ignition process all the electrodes will spark simultaneously when any burner is selected. Once the ignition process is complete, the flame ionizes the surrounding air which completes the sensing circuit and satisfies the module that a flame is present.

## Sparking

- Input voltage should be 240 VAC and the ground line should be properly connected to the range chassis. Voltage should be measured on one leg of the power supply.
- Make sure electrical circuit is properly polarized.
- If the igniter electrodes continue to spark after the burners are lit, check that each burner component is assembled and seated properly by observing uniform gaps between each layer. Disassemble and reassemble as required.
- If water spills onto the electrode, the burner will not reignite. The wet electrode will conduct spark energy to ground, preventing it from sparking or sensing flame across the spark gap. The burner will operate normally once the electrode and wiring connections are dry.

## Spark Module

All 36-in. and 48-in. models have a single spark module located behind the manifold/valve panel.

### To remove the module:

1. Remove the manifold/valve panel (see **Component Access**).
2. Remove the screws at the upper-right and lower-left corners of the module.
3. Pull the module up and out.

36-in. Model Shown

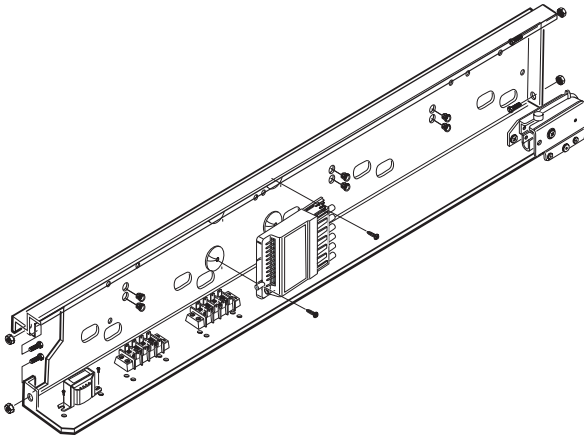

## 30-in. Range Models

30-in. range models have a single spark module located in the center of the burner box.

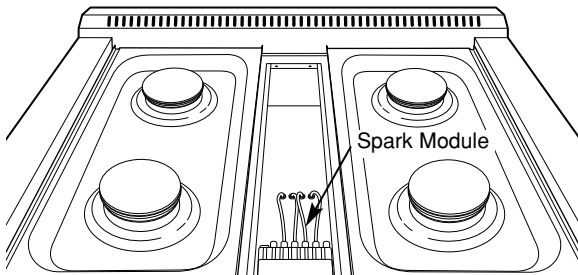

### To remove the module:

1. Remove the burner grates.
2. Lift off the center trim from the burner maintop.
3. Remove the 2 screws at the front and rear of the air duct cover, and remove the cover.
4. Remove the 2 screws securing the spark module to the range.

## Grill Burner/Griddle Burner Ignition Systems (On Some Models)

The grill burner and griddle burner are ignited by Norton style glowbar ignition systems. The ignition circuit consists of the grill switch (grill burner only), griddle thermostat (griddle burner only), the igniter and the thermal/safety valve (gas valve). The components are wired in series for each cooking function.

**Note:** The igniter resistance decreases as the igniter surface temperature increases. The safety valve operates by current, not by voltage.

From a cold start, the igniter needs 30–60 seconds, with voltage applied, to reduce its electrical resistance enough to provide a minimum of 3.2 - 3.6 amps of current flow in the series circuit. This is the required current flow needed for the safety valve to open and supply gas to the burner.

The glowbar should provide a steady current flow of 3.2 to 3.6 amps flowing in the circuit. At that point, the igniter temperature is between 1800°F and 2500°F. The igniter will remain energized at all times during burner operation. If the igniter glows red but does not draw at least 3.2 - 3.6 amps, the fault is usually with the igniter, not the valve.



## Grill Removal

### To remove the grill burner assembly:

1. Remove the grill cover, grill grates and grill radiant.
2. Lift off the front trim from the front of the grill.
3. Remove the 2 Phillips head screws at the front of the grill box that secure the grill box to the cooktop.
4. Carefully lift up the grill box enough to access the wire nut connecting the igniter to the neutral, and unscrew the nut. Unplug the wire going to the valve.
5. Lift the grill up and off the cooktop.

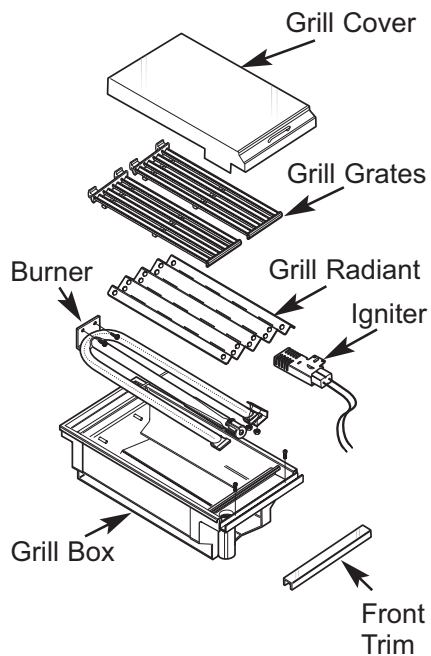

## Griddle Removal

### To remove the griddle assembly:

1. Remove the griddle cover.
2. Lift off the front trim from the front of the griddle.
3. Remove the 2 Phillips head screws at the front of the griddle that secure the griddle to the cooktop.
4. Remove the rear cover from the rear of the griddle.
5. Remove the center shipping screw and washer, if they have not already been removed.

**Note:** Do not remove the 2 outer leveling screws.

6. Lift the griddle assembly out of the opening and pull out the thermostat capillary from beneath the plate.

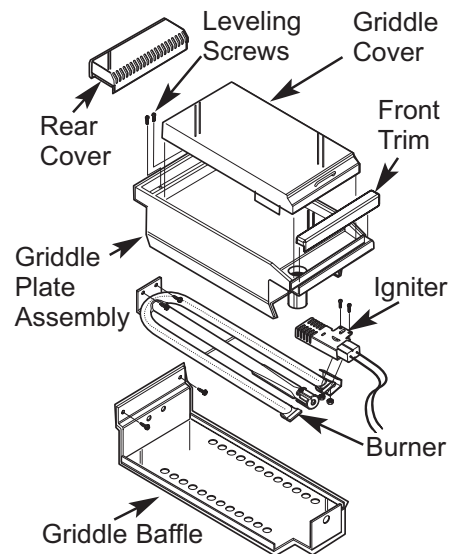

## Griddle Leveling

The 2 screws at the rear of the griddle plate assembly are leveling screws. They can be turned to level the griddle or to provide a forward slope to help grease and oils to drain away from the food being cooked.

## Griddle Thermostat Adjustment

### To adjust the griddle thermostat:

1. Pull the griddle control knob off.
2. On the back of the knob, loosen both screws, but do not completely remove.
3. With the back of the knob facing you, hold the outer edge of the knob with one hand and turn the back of the knob with the other hand.
4. To raise the griddle temperature, turn the back of the knob clockwise. To lower the griddle temperature, turn the back of the knob counterclockwise.
5. After the adjustment is made, retighten screws so they are snug, and replace knob.

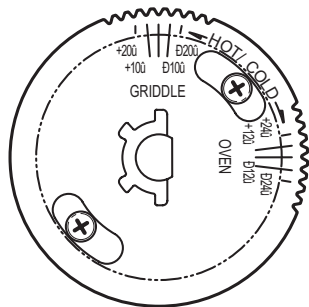

## Grill or Griddle Air Adjustment

1. For the grill, remove the grill cover, grates and grill radiant. For the griddle, remove the griddle assembly (see **Griddle Removal**).
2. If adjusting the grill air shutter, remove the 2 Phillips head screws at the rear of the burner and lift the burner out.
3. Loosen the screw on the burner air shutter using a flat head screwdriver.
4. Using a flat head screwdriver, move the air shutter in the appropriate direction. If the flame is too yellow, indicating insufficient air, adjust the shutter counterclockwise to increase the airflow. If the flame is too low or tends to lift away from the burner, indicating too much air, turn the shutter clockwise to reduce the airflow.
5. Test and adjust as needed for proper flame characteristics.

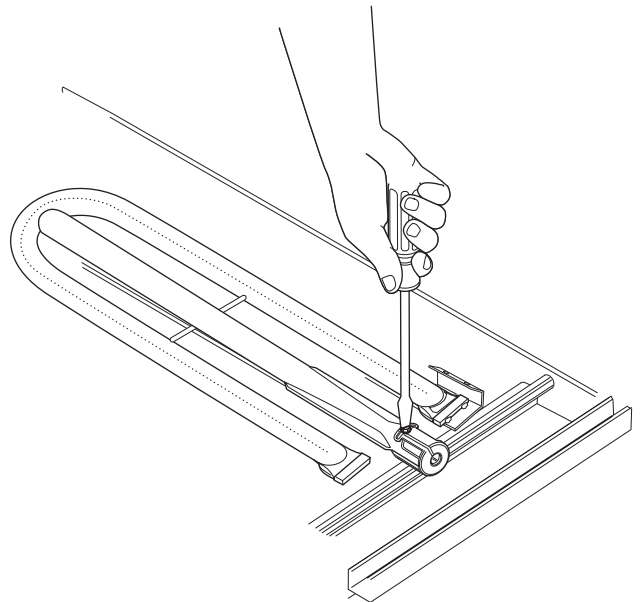

## Grill or Griddle Igniter Removal

1. For the grill, remove the grill cover, grates and grill radiant. For the griddle, remove the griddle assembly (see **Griddle Removal**).
2. Remove the 2 Phillips head screws at the rear of the burner and lift the burner out.
3. Remove the 2 flat head screws holding the igniter to the support bracket on the burner.
4. Replace with new igniter and replace all parts.

**Note:** When aligned properly, the dimple on the igniter bracket should fit into the notch on the support bracket on the burner.

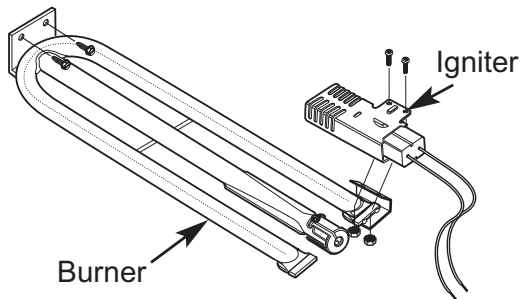

## GRILL OR GRIDDLE OHMMETER TEST

COMPONENT	OHMS
IGNITER	45-400 OHMS COLD
VALVE	1.0 to 1.2 OHMS
SWITCH	0 OHMS CLOSED

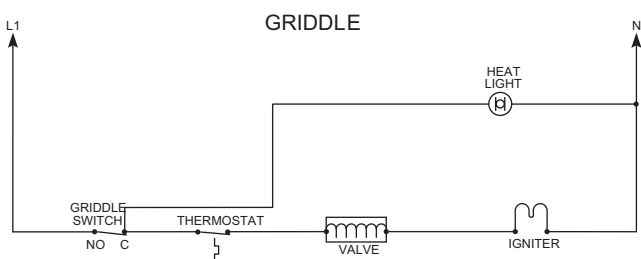
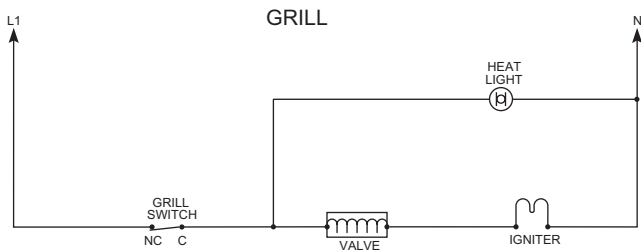

## Oven Thermostat Calibration

The AVERAGE center oven temperature should be 350° ±15°F for baking at the 350°F setting. Customers may change the average center oven temperature by ±24°F to satisfy their own cooking needs.

### To adjust the oven thermostat:

1. Pull the oven control knob off.
2. On the back of the knob, loosen both screws, but do not completely remove.
3. With the back of the knob facing you, hold the outer edge of the knob with one hand and turn the back of the knob with the other hand.
4. To raise the oven temperature, turn the back of the knob clockwise. To lower the oven temperature, turn the back of the knob counterclockwise.
5. After the adjustment is made, retighten screws so they are snug, and replace knob.

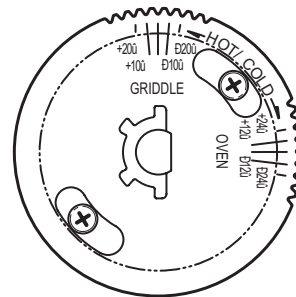

## Blower Thermal Cutout

The thermal cutout will turn on the blower in any mode of operation when it detects a temperature in the control area of approximately 210°F. The blower will cycle off when temperatures cool below 120°F.

## Oven Select Switches

Select switch operation can be checked with ohmmeter and strip circuits that show what contacts are closed in each mode of operation.

27-in. Oven

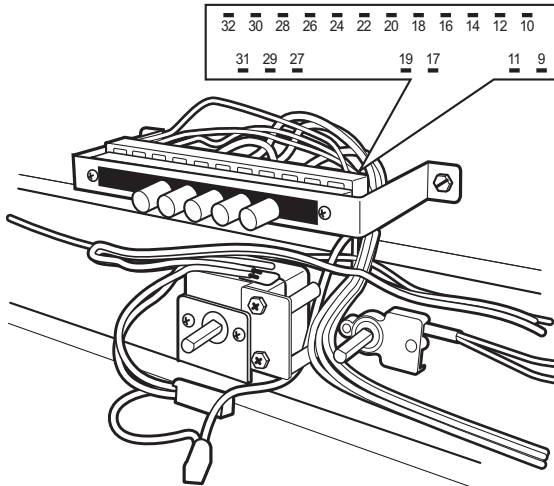

12-in. Oven

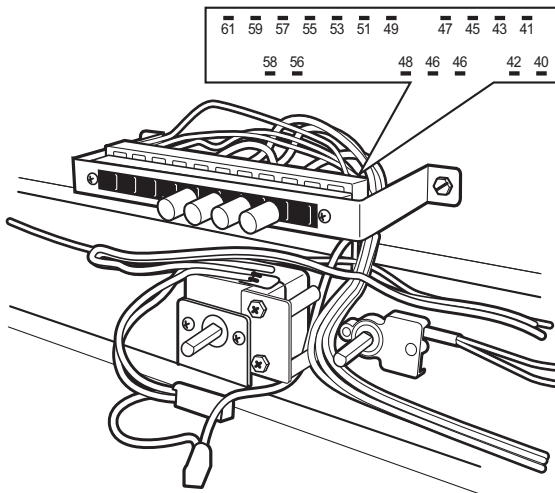

## Oven Thermostat

The operation of the thermostat contacts can be checked with an ohmmeter and strip circuits.

Contacts 1 and 2 are the cycling contacts, which are controlled by the expansion and contraction of the helium in the capillary. Contacts 7 and 8 will always be in the CLOSED position, except when in the CLEAN mode of operation. (See above illustration.)

## Relays, Convection Pulsar Timers and Main Power Connection

Electrical relays and timers are located in the compartment below the oven.

Remove the 2 screws from the top corners of the bottom panel and pull straight off.

48-in. Range Models

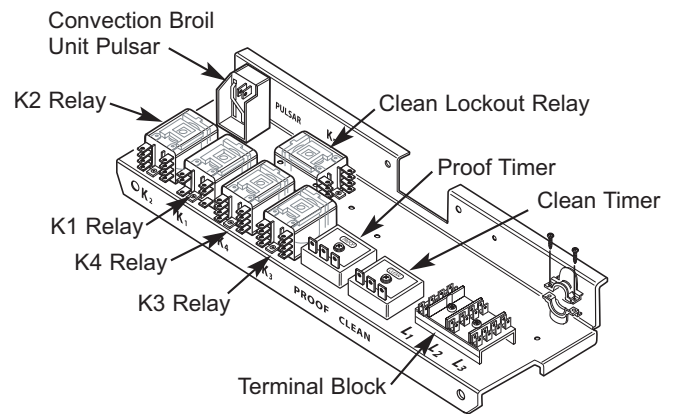

30-in. and 36-in. Range Models

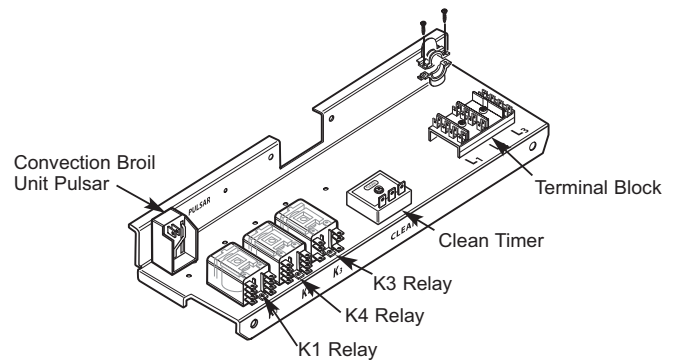

## Convection Fan Assembly

The convection fan assembly is located behind the large oven liner.

### To remove the convection fan assembly:

1. Disconnect power and remove the oven door and racks.
2. Loosen the fan cover mounted by 4 screws and spacers. Lift the cover off the keyhole opening.
3. Remove the 4 screws securing the fan assembly to the mounting plate.
4. Carefully pull the fan assembly into the oven.

**Note:** Fan assembly is heavy.

5. Disconnect the wires to remove the assembly from the oven, and place the assembly on a flat surface for repair.

### 36-in. and 48-in. Range Models

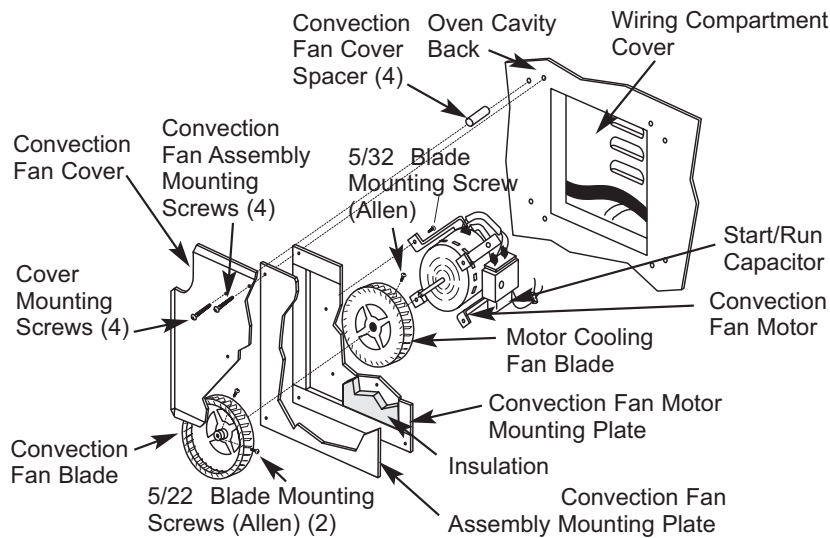

### 30-in. Range Models

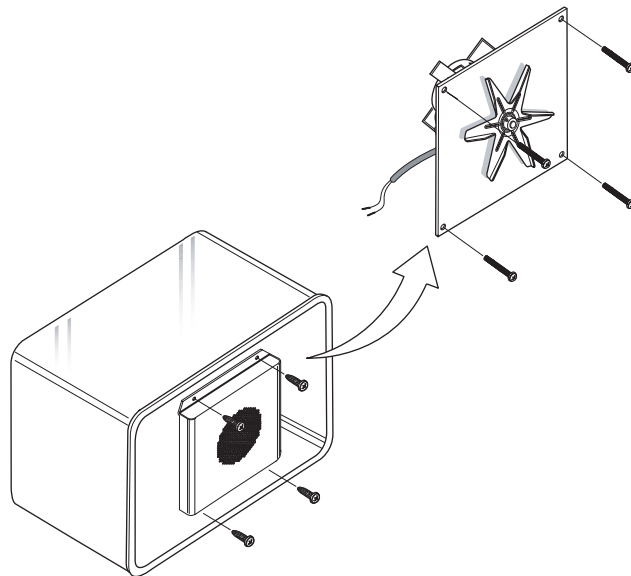



## Lock Motor Assembly

The lock motor assembly is located at the center top of the oven front frame. The assembly consists of the mounting plate, motor, micro switches, cam and hook assembly.

### To access the assembly:

1. Open the oven door.
2. Remove the 2 Torx screws securing the mounting plate to the front frame and pull the assembly out.

### Door lock motor operation:

1. When the oven controls are set for CLEAN, power is applied to the K3 relay coil, which will energize the lock motor.
2. The lock motor drives the cam that closes the latch CLOSED switch. As the lock hook engages, the motor position switch will open, supplying power to the K1 relay, which turns the clean timer on.
3. At the end of the clean cycle, when the select switch is pushed to off or another mode of operation, the K4 relay will energize the lock motor to drive the cam to the unlock position.

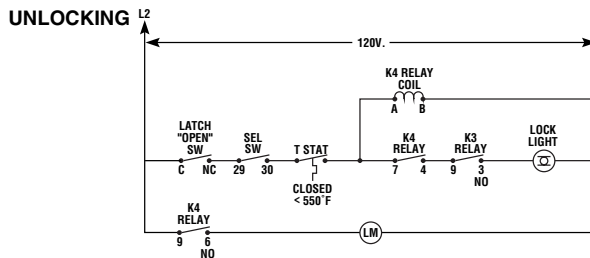
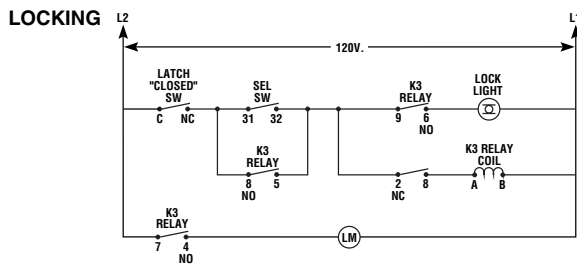
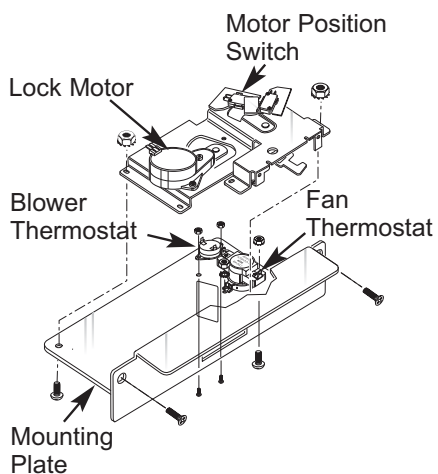

## Oven Blower Motor (36-in. and 48-in. Range Models)

The blower motor assemblies are located on the back of the range above each oven.

The air switch on the blower motor completes the circuit to the oven thermostat.

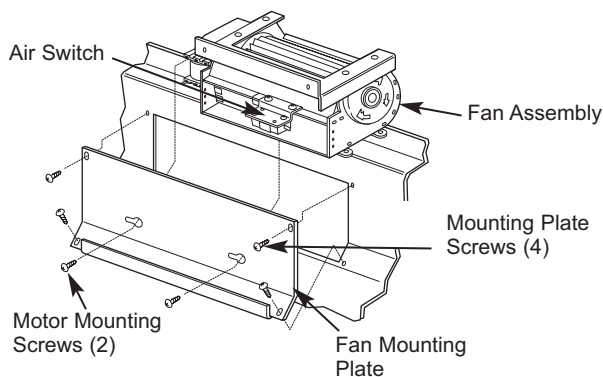

### To remove the blower assembly:

1. Remove the cooktop burner assemblies.
2. Remove the 4 screws securing the fan mounting plate, and pull the plate with attached blower motor forward.
3. Remove the blower motor from its mounting plate by loosening the 2 screws on the plate and sliding the blower to the right.
4. Install in reverse order.

## Oven Blower Motor (30-in. Range Models )

The blower motor assembly is located on the back of the range above the oven. The air switch on the blower motor completes the circuit to the oven thermostat and hot wire relay.

### To remove the blower assembly:

1. Lift off the burner cap.
2. Remove the left-side burner assembly and disconnect the ignition wires.

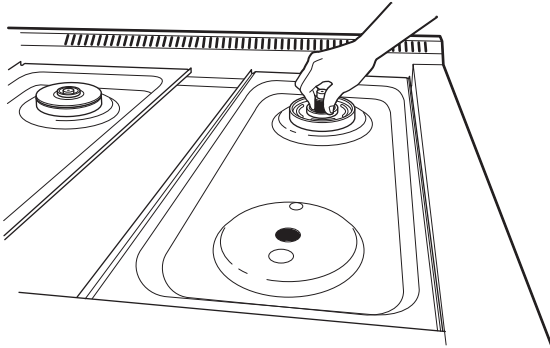

3. Remove the screws at the front and back of the air duct cover to reveal the spark module. (See **Spark Module**.)
4. Lower the manifold/valve panel. (See **Component Access**.)
5. Locate the bracket holding the oven thermostat in place. Remove the 2 screws securing the bracket, and pull the thermostat out of the way to reveal the re-ignition module bracket.

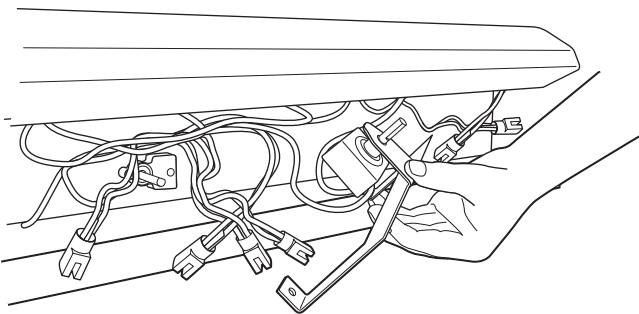

6. Remove the screw from the re-ignition module bracket.

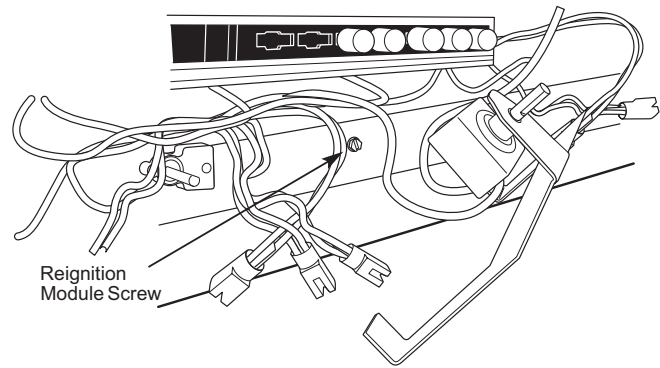

7. On the spark module, cut the wire tie securing the module, and disconnect the spark module from the wire harness by pulling straight off the connector.

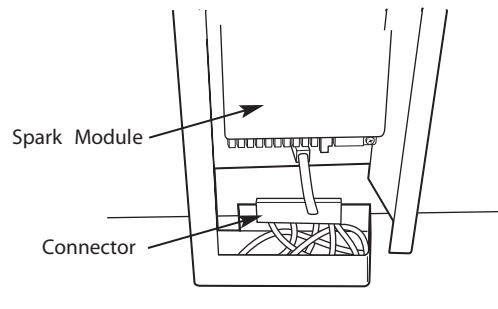

8. Lift the air duct out (with the wires still connected to the spark module), and set it aside.

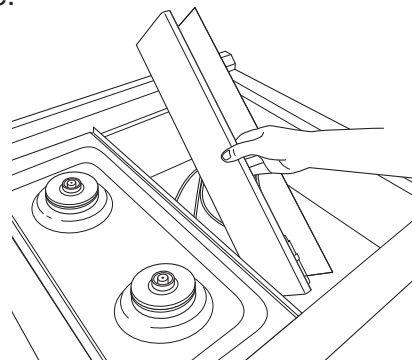

9. Locate the blower motor cover at the center rear of the burner box. Remove the 2 screws securing the blower motor cover, and lift the blower motor up and into the burner box.

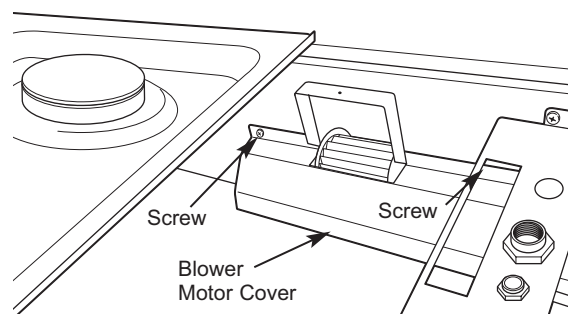

# Schematics and Wiring Diagrams

**WARNING:** Disconnect electrical power before servicing.

**Caution:** Label all wires prior to disconnection. Wiring errors can cause improper and dangerous operation. Verify operation after servicing.

## Oven Circuits

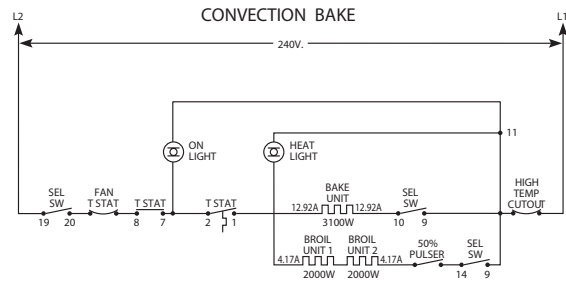
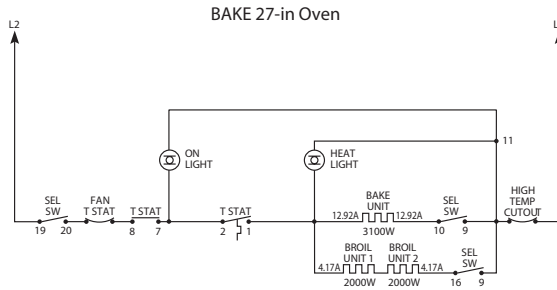

- During bake operation the broil unit is on 1/4 wattage while bake unit is energized.

- The Convection Fan will turn on as soon as the CONV switch is pressed and will remain on until the OFF switch is pressed or another mode of operation is selected.
- Throughout the convection mode, anytime the bake unit cycles on, the broil unit will be cycled at approximately a 50% rate at 120 volts.

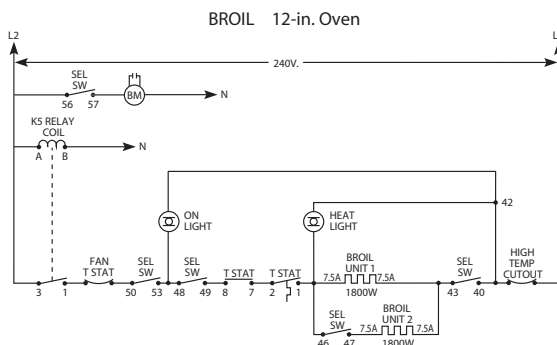
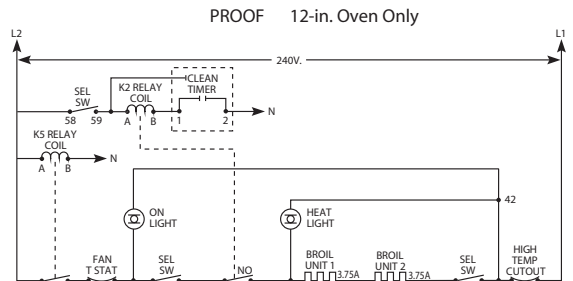
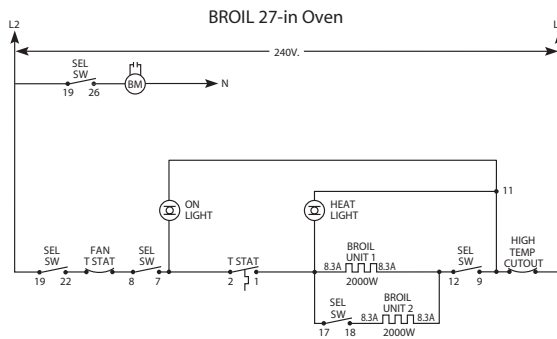
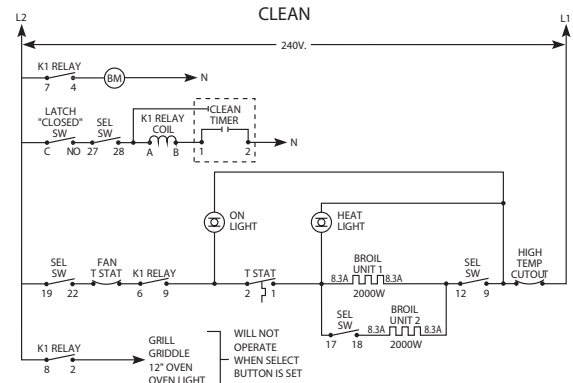
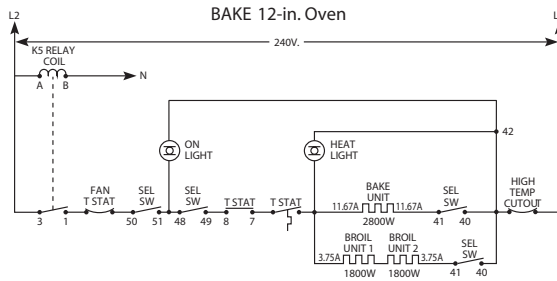

# 36-in. Range Wiring Diagram

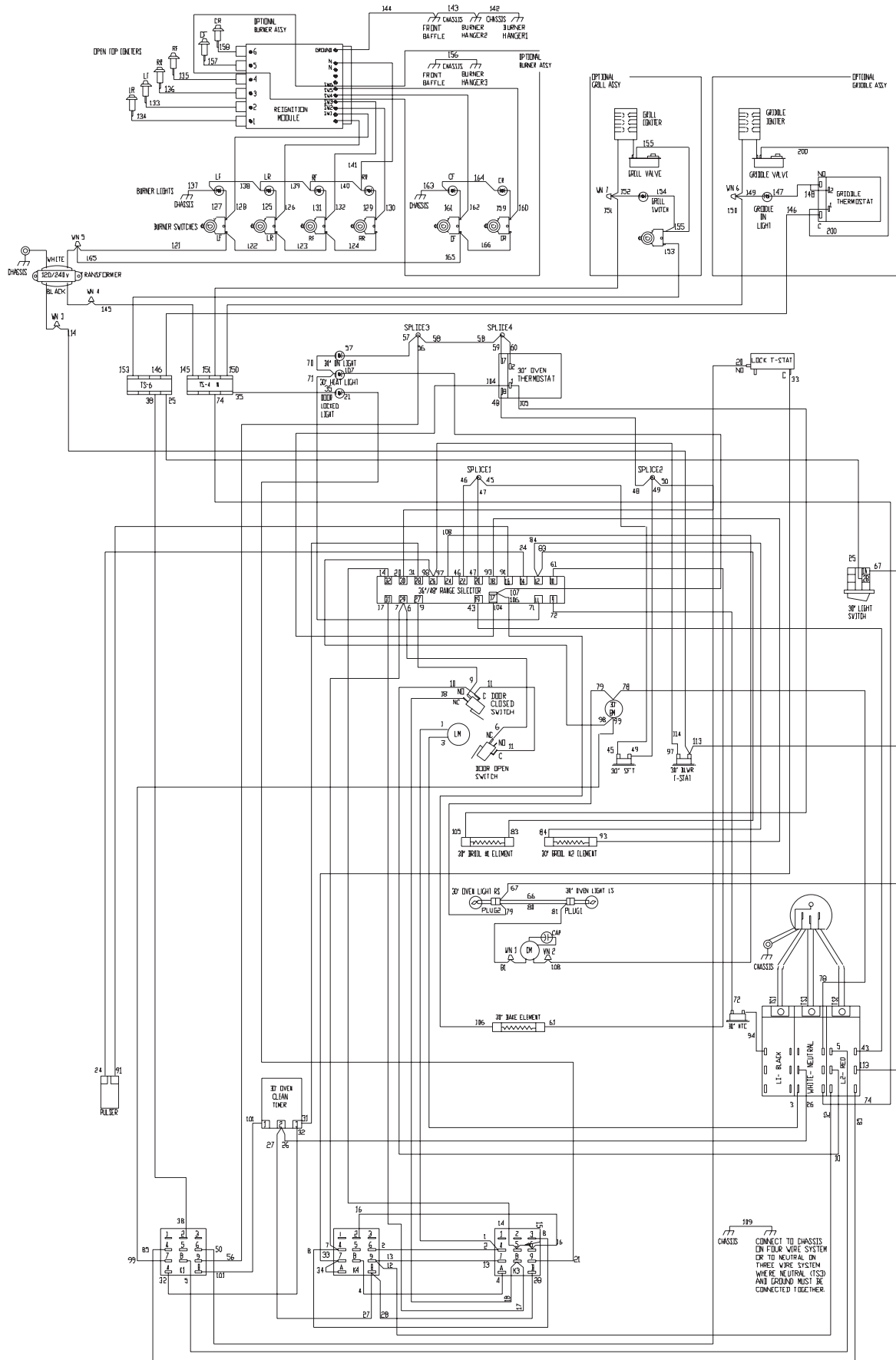

# 36-in Range Schematic

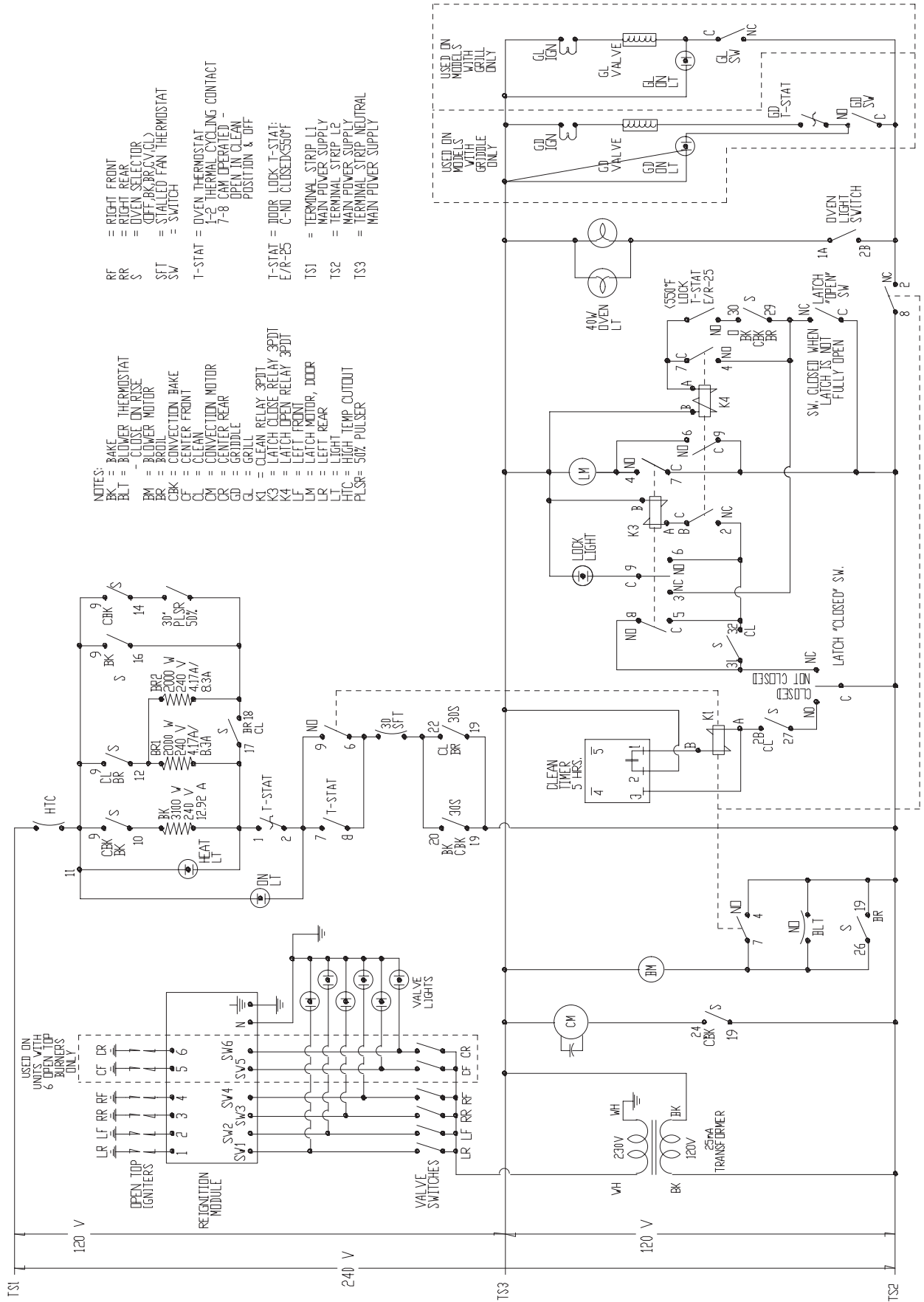



# 48-in. Range Wiring Diagram

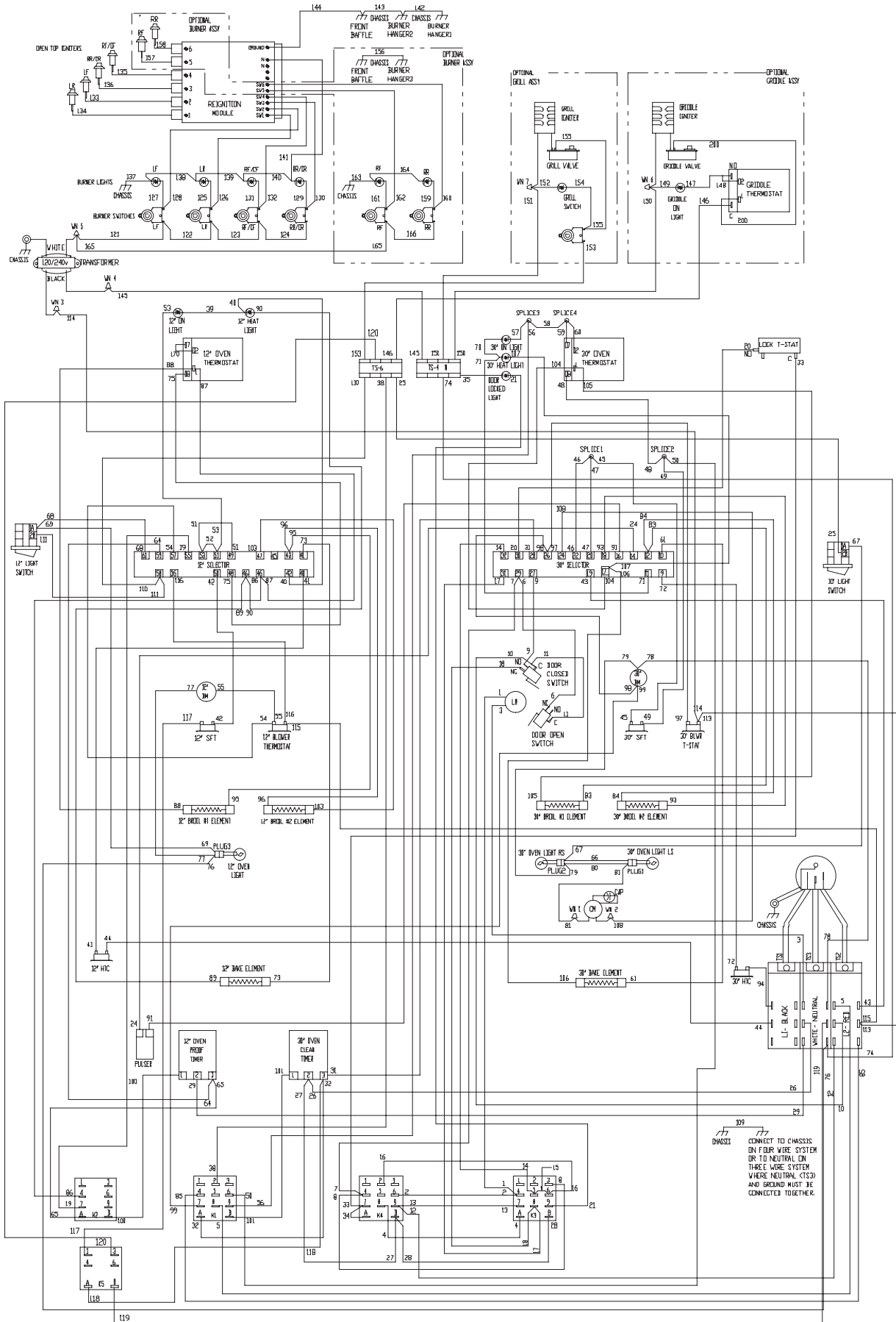

# 48-in Range Schematic

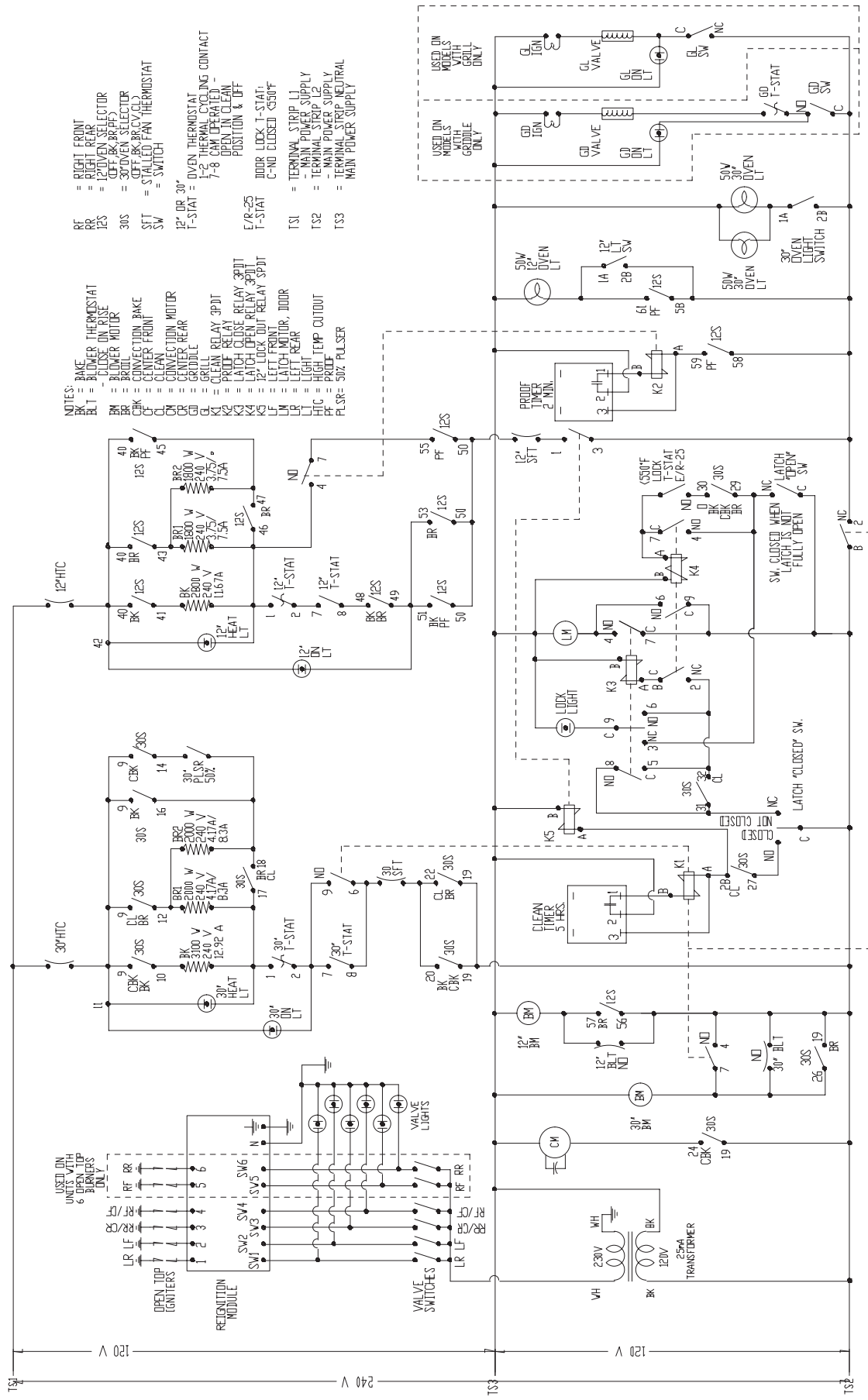

- NOTES:
- BK = BAKE
  - BLT = BLOWER THERMOSTAT
  - BR = BLOWER MOTOR
  - BR1 = CONVECTION BAKE
  - BR2 = CONVECTION FRONT
  - BR3 = CONVECTION REAR
  - BR4 = CLEAN RELAY MOTOR
  - BR5 = CLEAN RELAY
  - BR6 = CLEAN RELAY SPDT
  - BR7 = LATCH OPEN RELAY SPDT
  - BR8 = LATCH CLOSE RELAY SPDT
  - BR9 = LATCH FRONT
  - BR10 = LATCH REAR
  - BR11 = LATCH MOTOR, IDDR
  - BR12 = LIGHT
  - BR13 = LIGHT TOP OUTPUT
  - BR14 = PROOF
  - PLSR = 50% FULLSER
- RF = RIGHT FRONT
  - RR = RIGHT REAR
  - 12OVN = 12OVEN SELECTOR
  - 30S = 30OVEN SELECTOR
  - OFF BK, BR, PF
  - OFF BK, BR, CL, CR
  - ST = STALLED FAN THERMOSTAT
  - SW = SWITCH
  - 12" DR 30"
  - 12" T-STAT = OVEN THERMOSTAT
  - 1-2 THERMAL CYCLING CONTACT
  - 7-8 CAM OPERATED - OPEN IN CLEAN POSITION & OFF
  - IDDR LOCK T-STAT
  - C-NO CLOSED 5300F
  - E/R-25
  - T-STAT
  - TS1 = TERMINAL STRIP L1
  - L1 = MAIN POWER SUPPLY
  - TS2 = TERMINAL STRIP L2
  - L2 = MAIN POWER SUPPLY
  - TS3 = TERMINAL STRIP NEUTRAL
  - C-NO CLOSED 5300F

# 30-in Range Schematic

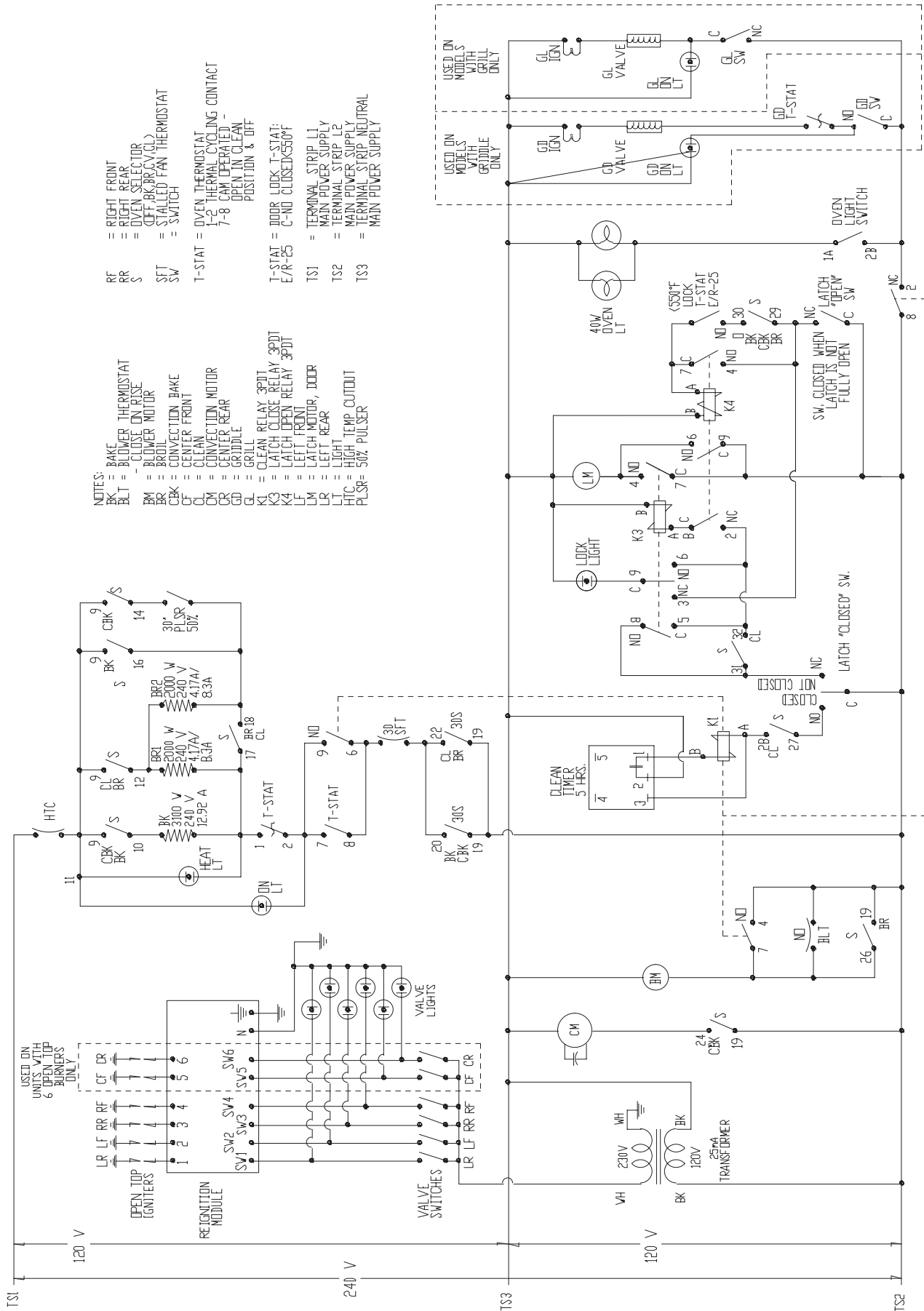

# 30-in. Range Wiring Diagram

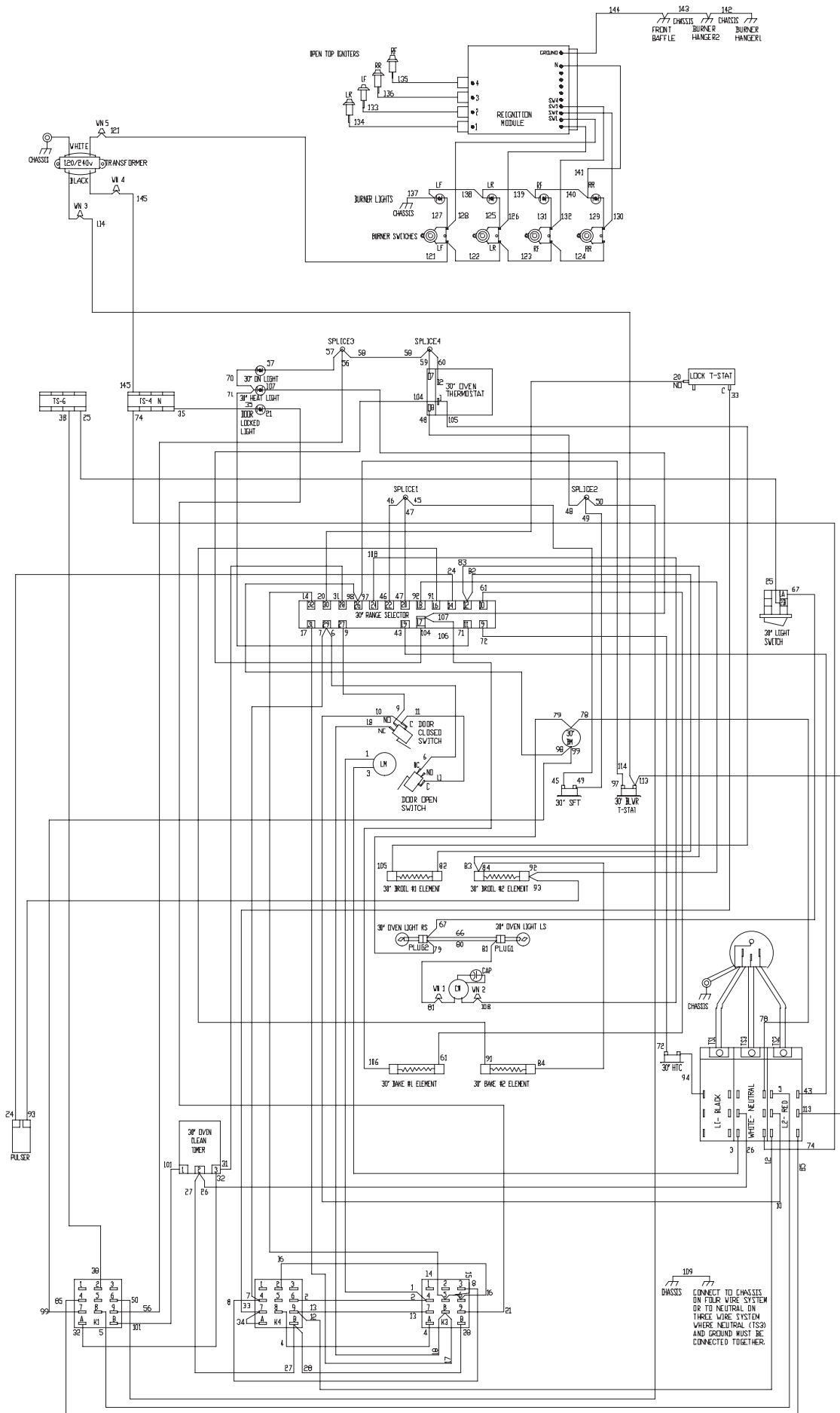

# Gas Cooktop Wiring Diagram

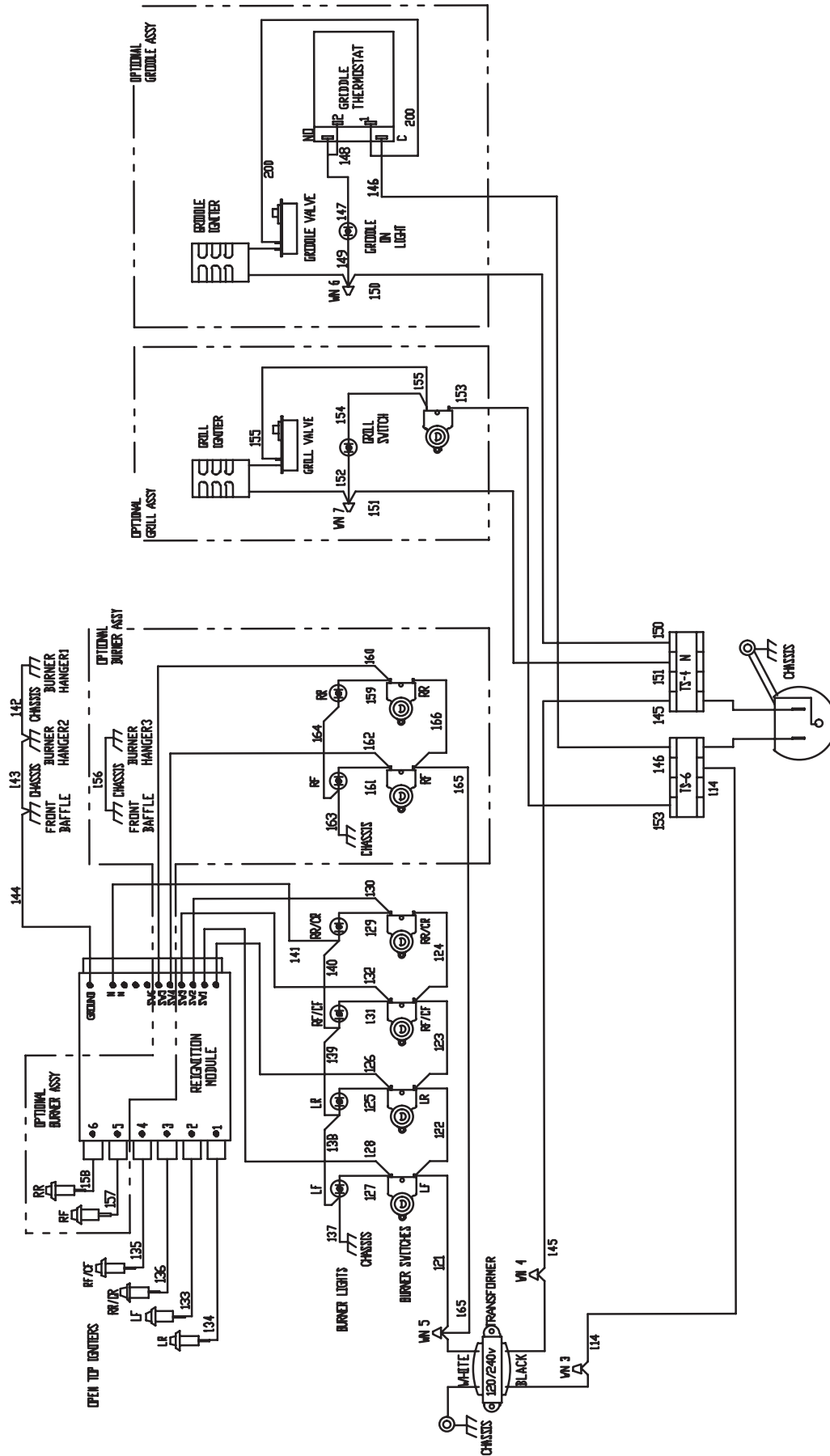

# Gas Cooktop Wiring Schematic

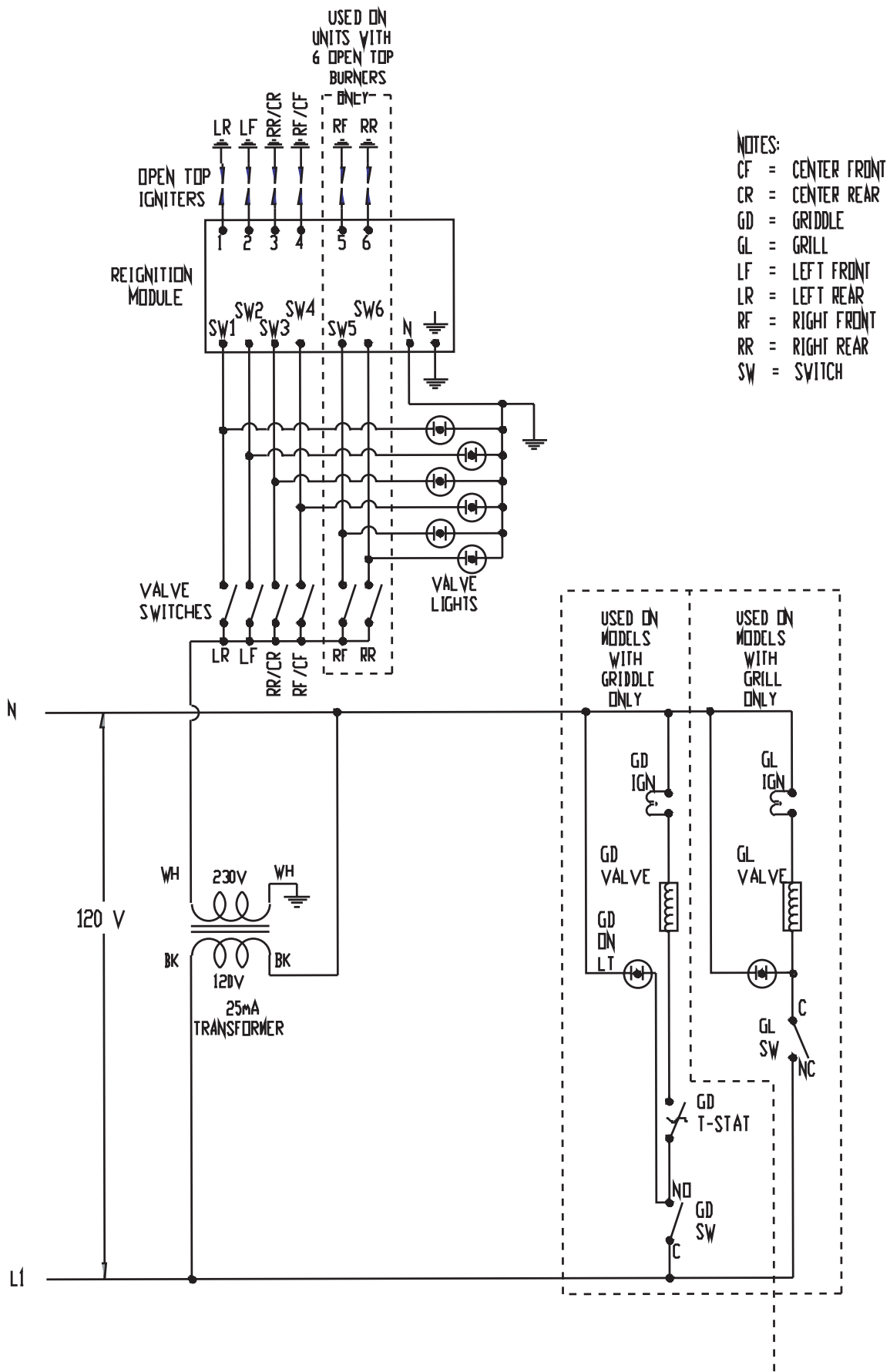



# Warranty

## MONOGRAM RANGE WARRANTY

*Proof of original purchase date is needed to obtain service under warranty.*

### WHAT IS COVERED

#### FULL ONE-YEAR WARRANTY

For one year from date of original purchase, we will provide, free of charge, parts and service labor in your home to repair or replace any part of the range that fails because of a manufacturing defect.

#### LIMITED FIVE-YEAR WARRANTY

For five years from the date of original purchase, we will provide, free of charge, replacement gas surface burners if they fail in normal household use. (The grill, griddle and oven burners are not included.) You pay for the service trip to your home and all service labor charges.

This warranty is extended to the original purchaser and any succeeding owner for products purchased for ordinary home use in the 48 mainland states, Hawaii and Washington, D.C. In Alaska the warranty is the same except that it is LIMITED because you must pay to ship the product to the service shop or for the service technician's travel costs to your home.

All warranty service will be provided by our Factory Service Centers or by our authorized Customer Care® servicers during normal working hours.

Should your appliance need service, during warranty period or beyond, in the U.S.A. call 800.444.1845. In Canada: 888.880.3030.

### WHAT IS NOT COVERED

- Service trips to your home to teach you how to use the product.
- Discoloration of the griddle plate.
- Chipping of porcelain enamel grates.
- Replacement of house fuses or resetting of circuit breakers.
- Incidental or consequential damage caused by possible defects with this appliance.
- Damage after delivery.
- Damage to the product caused by accident, fire, floods or acts of God.
- Failure of the product if it is used for other than its intended purpose or used commercially.
- Improper installation, delivery or maintenance. If you have an installation problem, contact your dealer or installer. You are responsible for providing adequate electrical, gas, exhausting and other connecting facilities as described in the Installation Instructions provided with the product.

Some states do not allow the exclusion or limitation of incidental or consequential damages, so the above limitation or exclusion may not apply to you. This warranty gives you specific legal rights, and you may also have other rights which vary from state to state. To know what your legal rights are in your state, consult your local or state consumer affairs office or your state's Attorney General.

Warrantor: General Electric Company. If further help is needed concerning

#### Natural Gas Models

ZDP48N4G  
ZDP48N6R  
ZDP48N6D  
ZDP36N6  
ZDP36N4R  
ZDP36N4D  
ZDP30N4

#### Liquid Propane Models

ZDP48L4G  
ZDP48L6R  
ZDP48L6D  
ZDP36L6  
ZDP36L4R  
ZDP36L4  
DZDP30L4